



GSD-RKIT INSTRUCTION MANUAL

Hardware Kit for Custom GSD-SDO Rail Length up to 6m

GSD-RKIT provides all the necessary hardware to custom manufacture an S-Drive rail to any length - up to a 6m high door.

The only material not supplied is the actual rail angle. Specifications of the rail angle are supplied below.

This manual illustrates how to assemble the rail kit together.

Rail Angle Specifications

Rail angles must be 50 x 50 x 3mm Duragal steel (or equivalent)

The variable length must be at least 900mm longer than the desired door height.

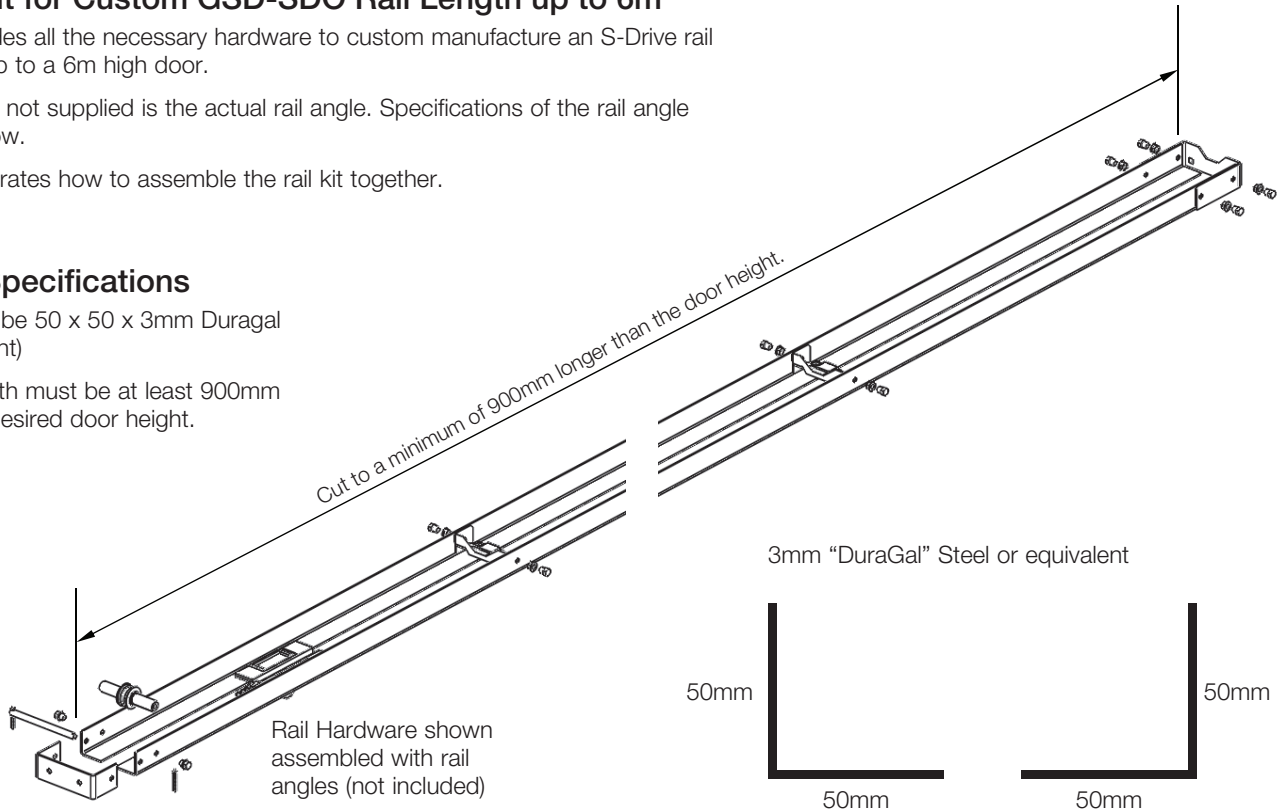

STEP 1

Position rails as shown below and use the powerhead bracket as a jig to mark out and drill two 10mm holes in each angle.

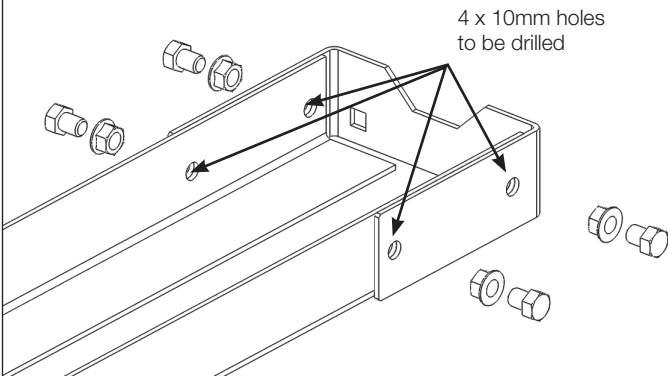

STEP 2

Move to the opposite end of the rails and mark out and drill positions, centred on each rail shown below.

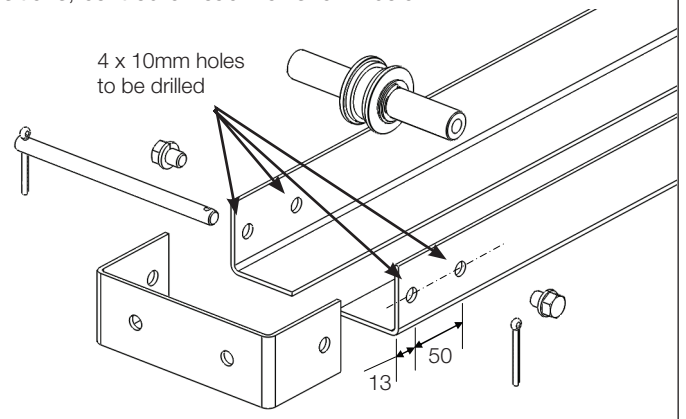

STEP 3

Mark out locations for track spacers (3 places). They should be equally spaced along the rails, no more than 1.715m apart. Drill a 10mm hole in each rail centred on the angle flat as shown.

**DO NOT ASSEMBLE ANY COMPONENTS YET.
REFER TO NEXT PAGE.**

2 x 10mm holes to be drilled

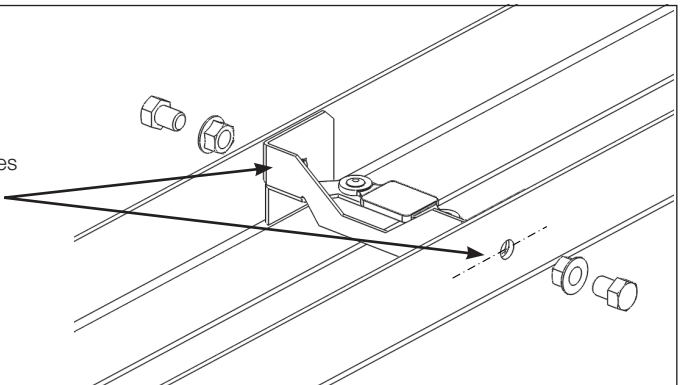

**THIS MANUAL IS A SUPPLEMENT TO THE GSD-SDO MANUAL
REFER TO THE GSD-SDO MANUAL FOR FURTHER INFORMATION**

STEP 4

Assemble power head bracket as shown.

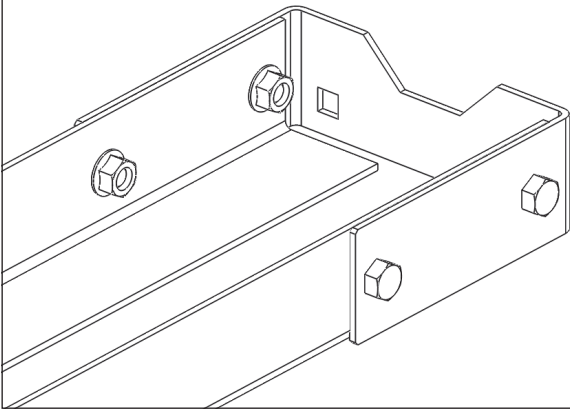

STEP 5

Assemble track spacers as shown.

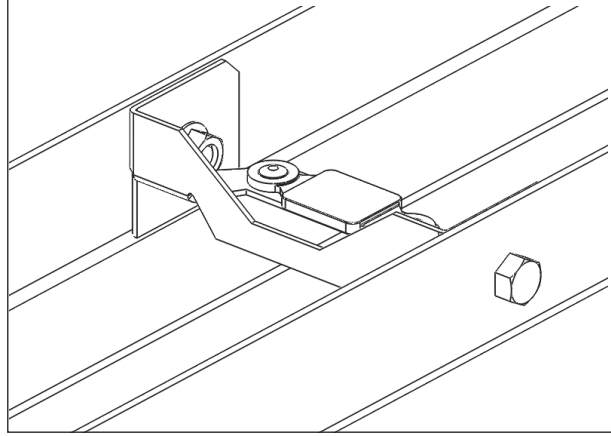

STEP 6

Position the trolley assembly as shown.

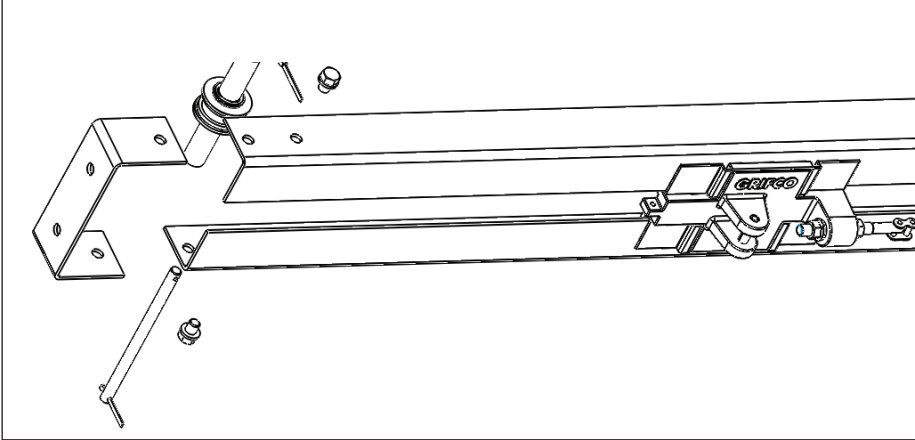

STEP 7

Assemble idler end. Leave one split pin straight for installation ease as header bracket will be mounted separately.

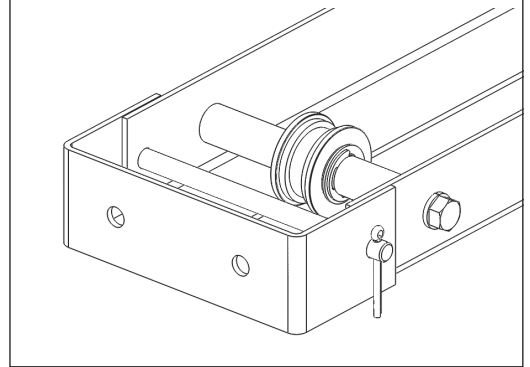

STEP 8

Position the rail so that the power head bracket meets the power head. Lace the chain as shown to determine length required. Connect the chain to the front end of the trolley using the connecting link.

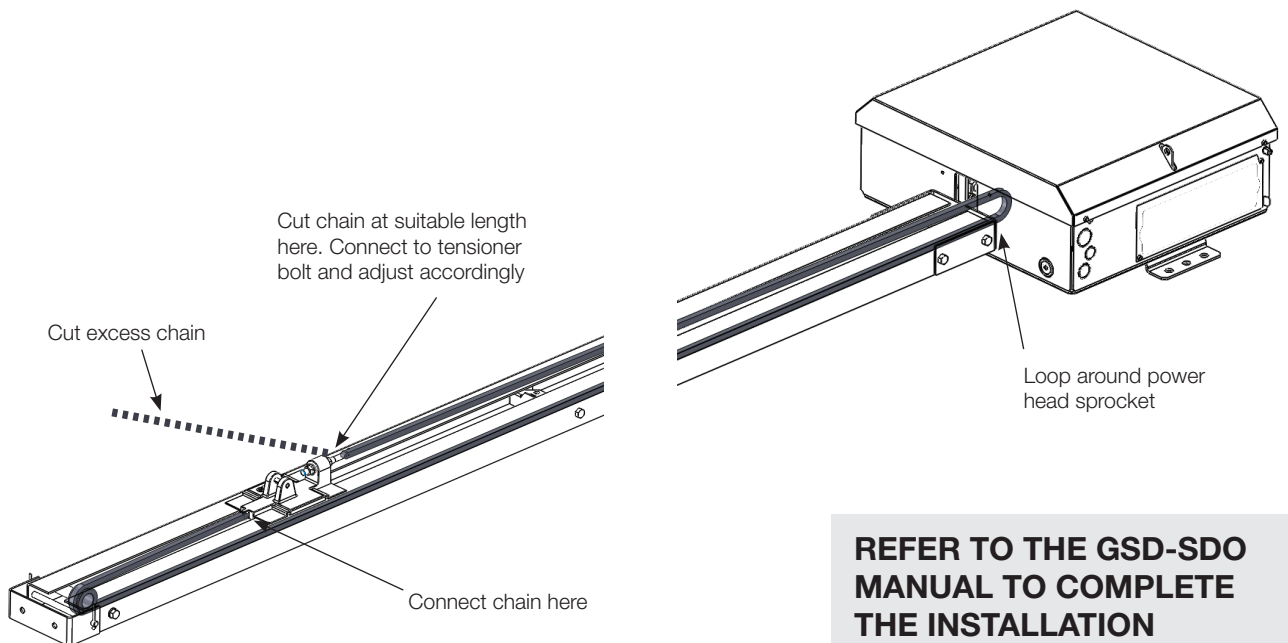

**THIS MANUAL IS A SUPPLEMENT TO THE GSD-SDO MANUAL
REFER TO THE GSD-SDO MANUAL FOR FURTHER INFORMATION**